

Comfortaire®

Check your contents

- A. Cover (1 cover with 3 parts zipped together)
- B. Foam Perimeter Support with Velcro Fasteners
(4 pieces: 2 long and 2 short)
- C. Air Core (2 for dual model; 1 for single model)
- D. IFC 2001 Air Control System (1)
- E. Zip Lock Clamp
(2 for dual model; 1 for single model)
- F. Black Rubber Plugs (2)
- G. Topper Foam (2)
- H. Base Foam (6 for dual model;
3 for single model)

Assembly Instructions

for

Royal Duchess
GS.700

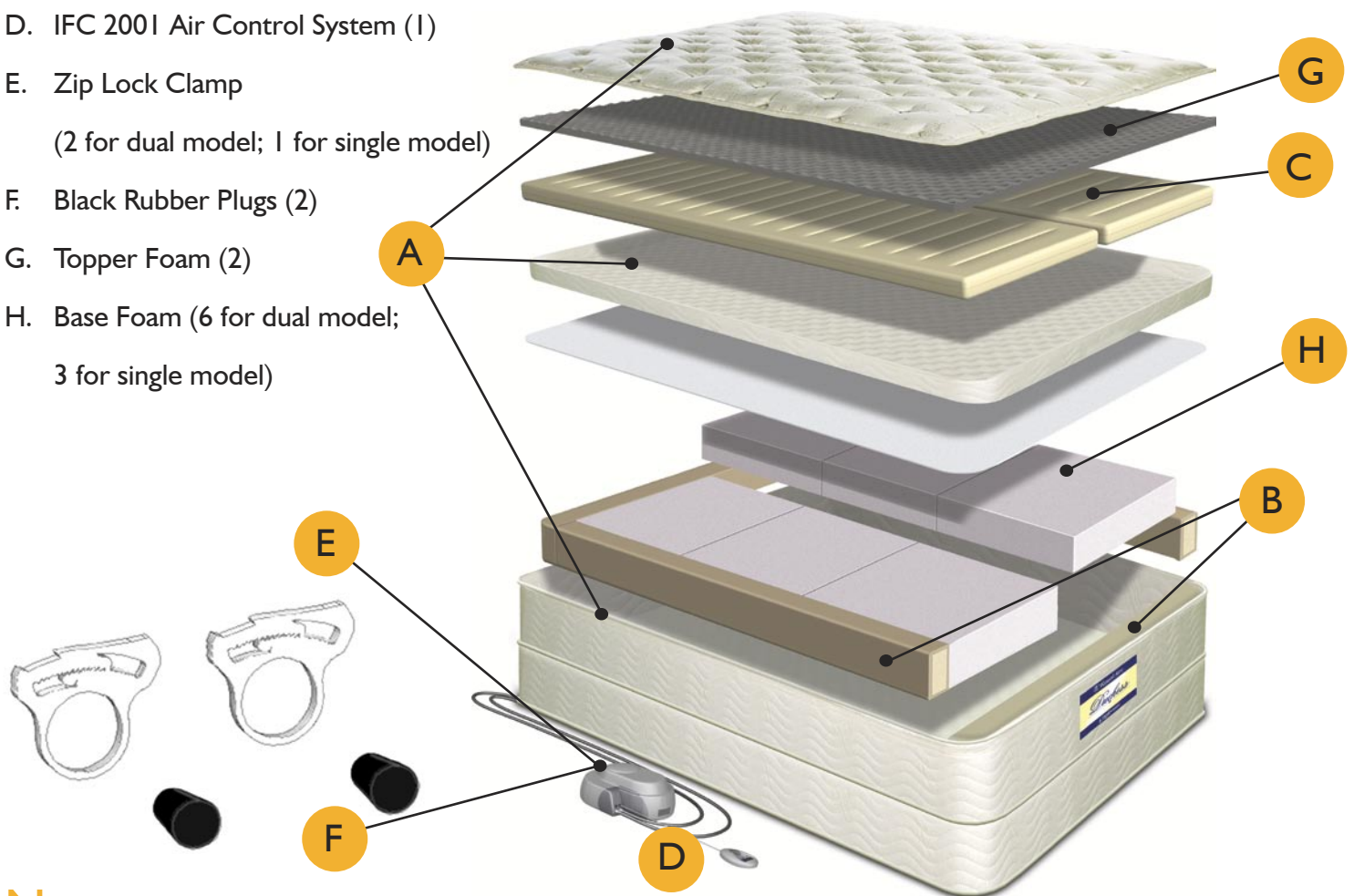

Notes

- * If anything listed above is missing, contact Customer Service at [1-800-759-0594](tel:1-800-759-0594) immediately.
- * You are now ready to begin assembling your Comfortaire mattress. If you purchased a box spring or foundation, assemble it first.
- * It will take approximately 30-60 minutes to complete the assembly process.
- * If, during the assembly or at any time, you have a question or problem, please consult the [troubleshooting guide](#) on page 6. If the guide does not provide a solution to the problem, contact Customer Service by phone at [1-800-759-0594](tel:1-800-759-0594) or by e-mail at customerservice@comfortaire.com
- * If, at any time, you misplace your owner's manual, you may find it on our web site at www.comfortaire.com.

Set up Foam Perimeter Support

- Remove cover from clear plastic bag.
- Place cover on box spring, foundation, or platform with quilted side of cover facing upwards and with mattress label at foot of bed (Fig. 1).
- Completely unzip cover, remove top panels, and set to side (Fig. 1).
- Retrieve foam perimeter support from box.
- With zipper sides facing downward, insert the short pieces into the head and foot of the cover. Then insert the two (2) long pieces with rectangular ends into each side of the cover (fig. 2).
- Align all four (4) corners and attached side foam to end foam using Velcro fasteners (Fig. 2).

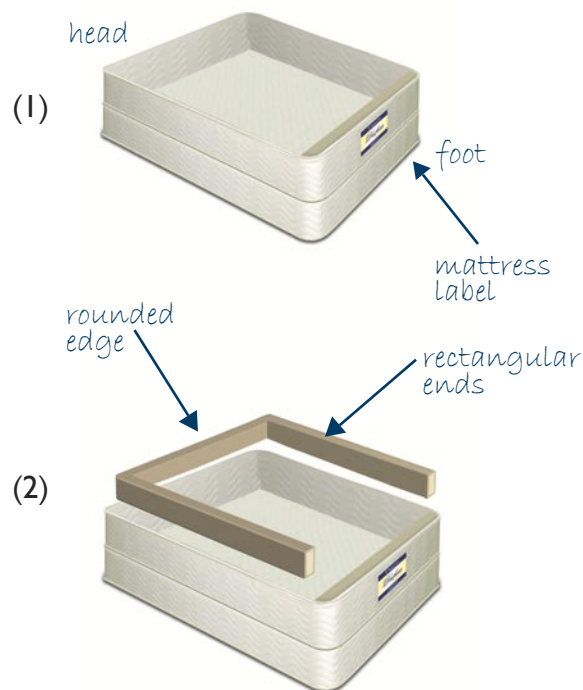

Insert Base Foam

- Retrieve base foam support pads from box.
- Insert base foam support pads into cover base (Fig. 3).
- **NOTE:** Base foam support pads are not square! Follow diagram for proper insertion.

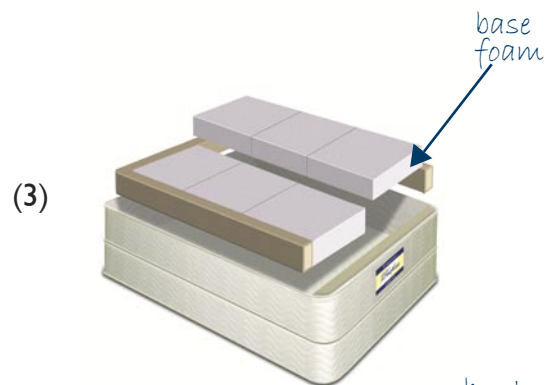

Attach Box Top Panel

- Retrieve Box top panel.
- Place box top onto mattress cover base and zip together.
- When zipping box top panel, be sure to pull both panels together to avoid breaking zipper (Fig. 4).

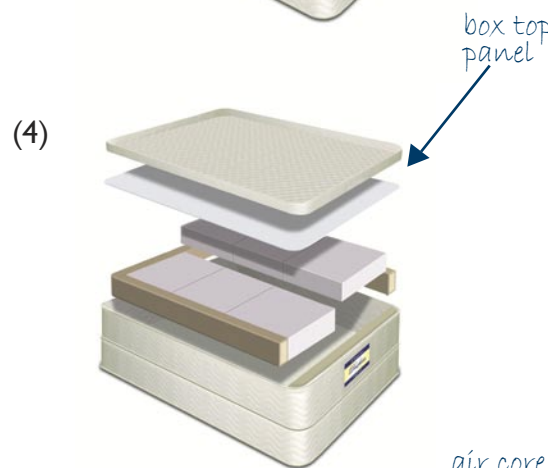

Insert Air Cores

- Retrieve air core(s) from box.
- With air hose(s) facing downward, lay air core(s) flat inside sidewall cavity (Fig. 5).
- Insert air hose(s) through pre-cut slots in the bottom of cover located at head of mattress.

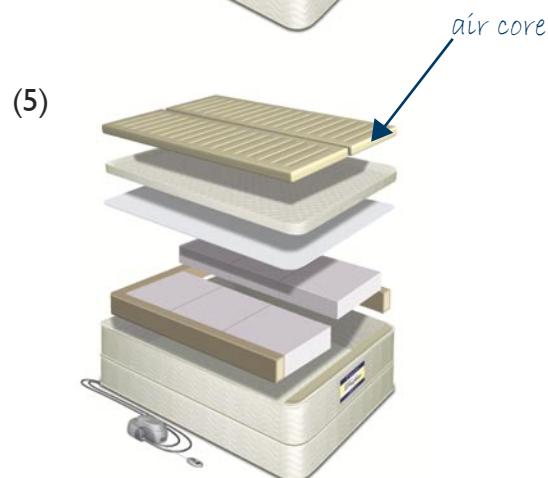

Set up Air Control System

- Remove air control unit, hand controls, and cord jacks from box.
- Insert cord jacks into controls and pump (Fig. 6).
- Attach air hose(s) to pump (Fig. 6).
- Attach zipper clamp(s) where air hose(s) connect to nozzle(s) (Fig. 6).
- Plug air control unit into power outlet.

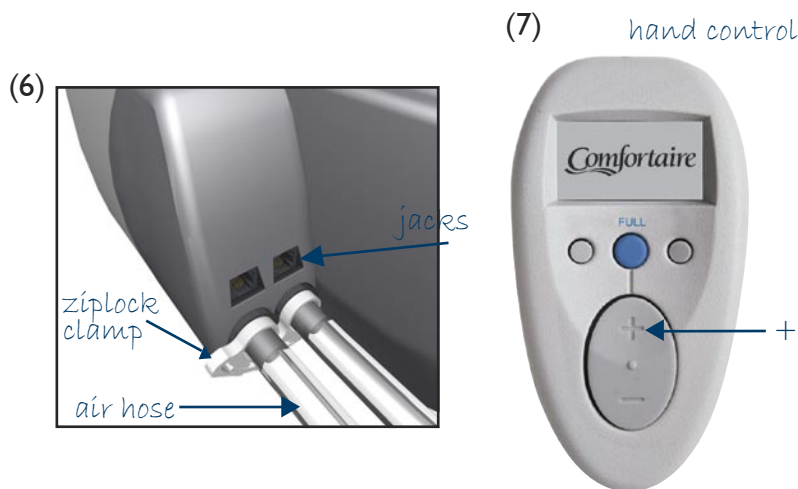

Inflate Air Core

- By pressing button marked "FULL" on hand control, allow chambers to inflate until pump stops (NOTE: you may inflate only one chamber at a time) (Fig. 7).
- Make sure that sidewalls are straight and pushed out to sides of mattress cover for nice, finished look.

Insert Topper Foam

- Unzip the top panel from the box panel and set the top panel aside.
- Remove topper foam from clear plastic bag.
- Cover air chambers with topper foam. Flat side of foam should touch chambers (Fig. 8).

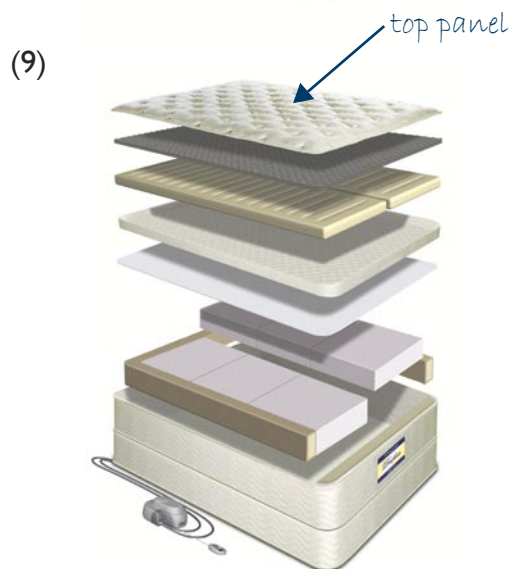
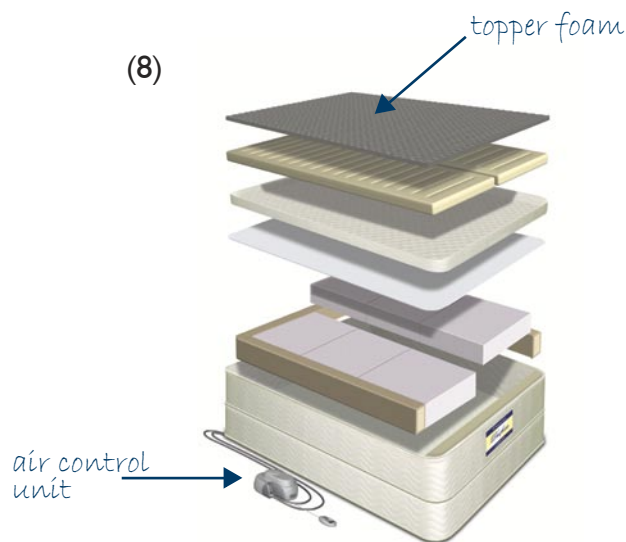

Finish Assembly

- Place top panel of mattress over the topper foam and zip together. When zipping top panel, be sure to pull top and bottom panels together to avoid breaking zipper.
- Assembled mattress (Fig. 10).
- Air control system may be placed under box spring, foundation, or platform.

